

POCN	REV	DATE	REVISIONS	DWN	DSGN	CHK	APPV
	△		INITIAL ISSUE				

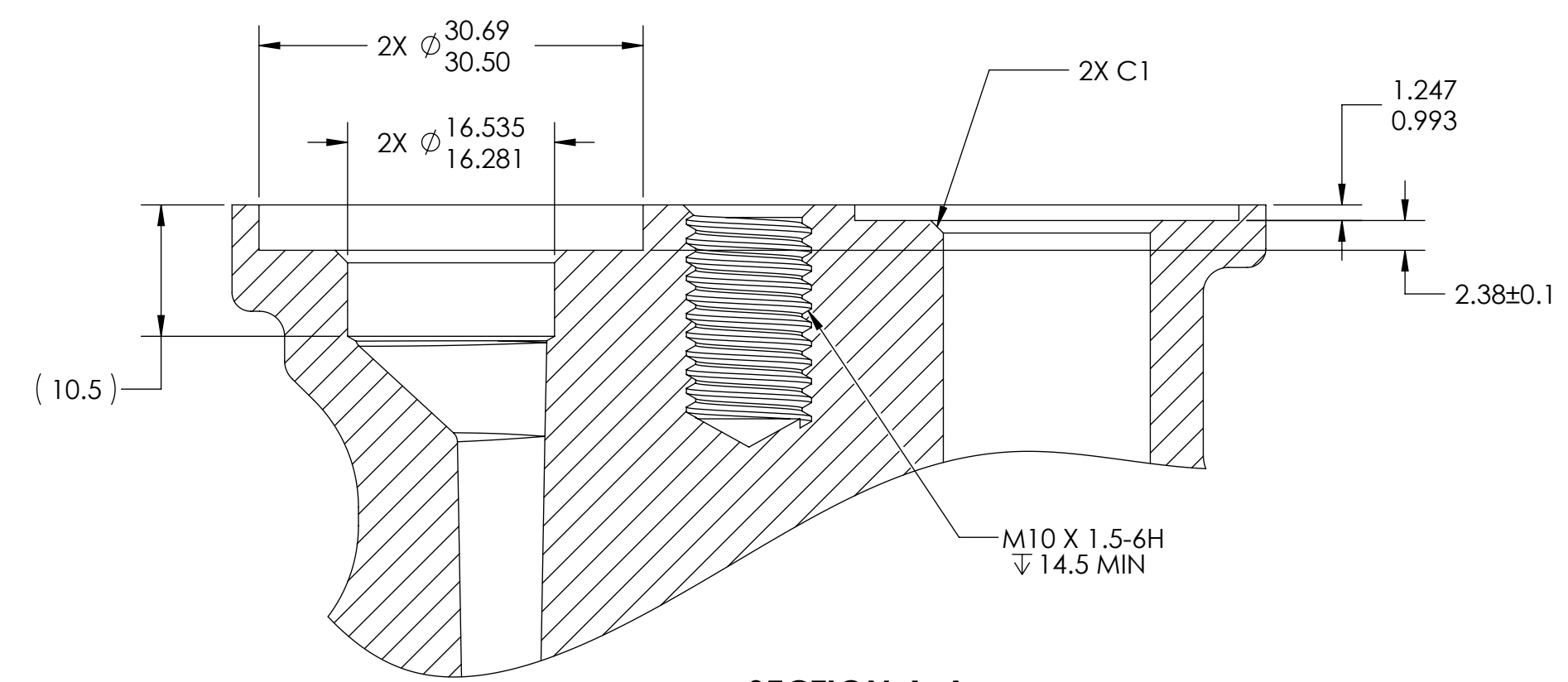

SECTION A-A
SCALE 2 : 1

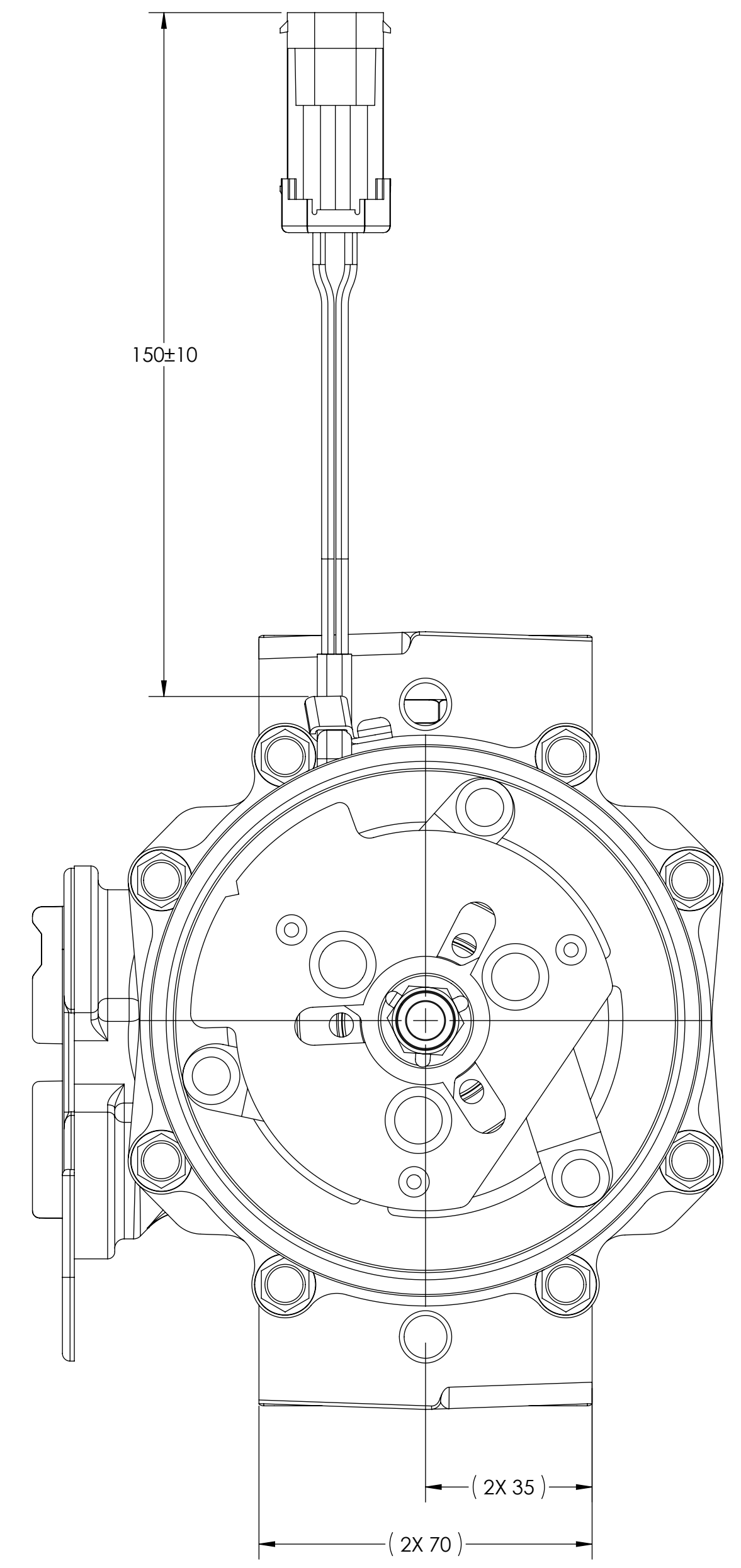
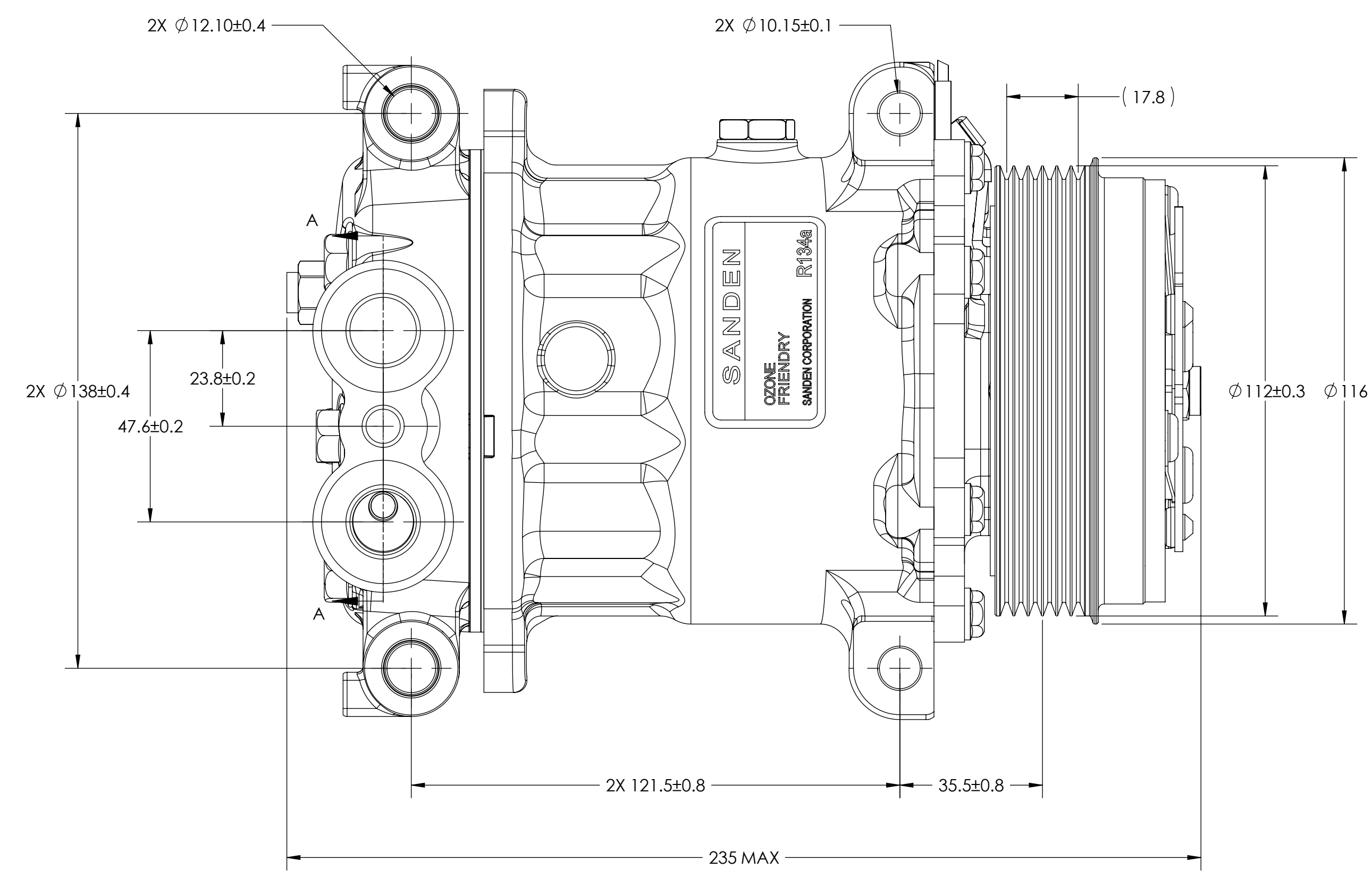
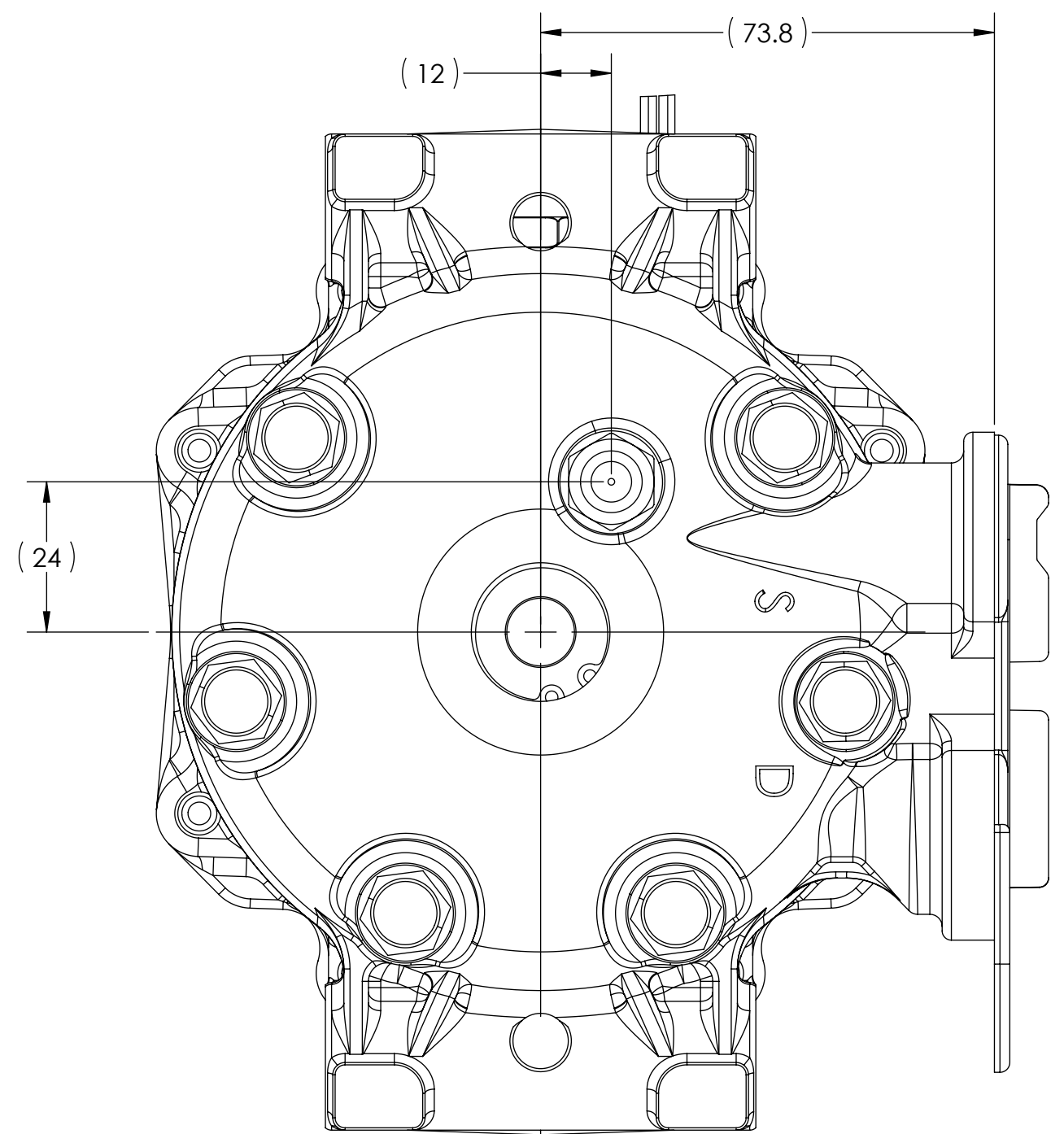

DISPLACEMENT PER REVOLUTION	155 cc
MAXIMUM ALLOWABLE ROTATIONAL SPEED	8000 RPM
MAXIMUM ALLOWABLE CONTINUOUS ROTATIONAL SPEED	6000 RPM
REFREIGERANT	134a
SP-15 OIL QUANTITY	135±10 cc

RATED VOLTAGE	12V
BREAKAWAY TORQUE	34 N·m
MINIMUM ENGAGEMENT VOLTAGE	7.5V
MAXIMUM POWER CONSUMPTION	49 W
BELT TYPE	PV6
MAXIMUM ALLOWABLE BELT TENSION	883 N
PULLEY DIAMETER	Ø 112 mm
CLUTCH TYPE	STANDARD

REV LEVEL	RELEASED FOR ENG DEVELOPMENT		METRIC DIMENSIONS SHOWN IN MILLIMETERS UNLESS OTHERWISE SPECIFIED.
DGN	A. ARMENDARIZ		
CHK	S. NAGARAJ		
APPV.	R. MARTINEZ	THE INFORMATION CONTAINED IN THIS DRAWING IS THE SOLE PROPERTY OF SANDEN INTERNATIONAL. ANY REPRODUCTION IN PART OR AS A WHOLE WITHOUT THE WRITTEN PERMISSION OF SANDEN INTERNATIONAL INC IS PROHIBITED.	
APPV. DATE	08/14/08	INTERPRETATION OF THIS DRAWING PER ASME Y14.5M-1994	
REV LEVEL	RELEASED FOR DESIGN VALIDATION	THRD ANGLE PROJECTION	
DGN	A. ARMENDARIZ	MATERIAL	
APPV.	R. MARTINEZ	NAME	
APPV. DATE	08/14/08	COMPRESSOR	
REV LEVEL	RELEASED FOR PRODUCTION	DWG. NO.	
DGN		4261-6000	
APPV.		REV	
APPV. DATE		A	